

Twist-Lock System

Wand employs a slide-and-twist mechanism.

UNLOCKED: Dots and channel align (left). **LOCKED:** Dots and channel offset (right).

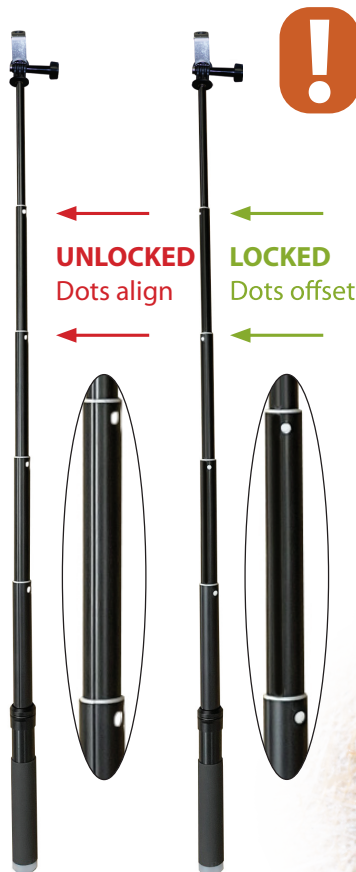

CAUTION

Use care when pulling and twisting the extension wand.
Excessive force will damage the wand.

To extend, hold wand as shown, pull wand head away from handle and carefully twist wand head counter-clockwise to lock.

To retract, hold wand as shown, carefully twist wand head clockwise, and push wand head toward handle.



www.rockwelllabs.com
800.891.8610
03015



Aprehend Spray Kit Trigger-Lock Extension Wand Assembly and Use

*Note: This extension kit is **only** for use with the Spray Gun with Trigger-Lock.*



*Legacy spray guns require
Trigger-Lock Retrofit Kit
P/N: APRS210
ConidioTec P/N: 30210*

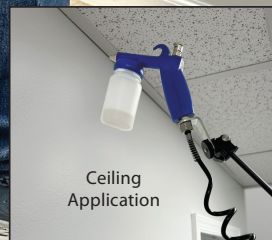

Spray kits and parts are available from your Aprehend supplier.
Contact your Rockwell Labs technical rep, or 800.891.8610 ext 0 if you experience any problems with this equipment.

Important: Before attaching the extension, ensure the sprayer bottle is empty and the battery is in off position. **When using the extension wand, the battery or compressor on/off switch should be used to activate the sprayer.**

1. Connect the extension wand to the spray gun as pictured in Figure 1.
2. Run system with empty reservoir to **confirm leak-free connections**—this will ensure proper compressor auto-stop operation during use.

If the compressor continues to run when trigger is not depressed, there is an air leak in the system:

- Verify Trigger-Lock is in the "OFF" (unlocked) position (Figure2).
 - Check and tighten the connections at both ends of the coiled hose.
 - An additional washer (supplied) may be required to ensure an airtight fit for the gun.
3. Confirm battery and compressor are in the "OFF" position.
 4. Press trigger to release system air pressure.
 5. Fill spray gun reservoir with Aprehend.
 6. Turn spray gun trigger-lock to "ON" (locked) position (Figure 2).
 7. Adjust the extension wand to desired length and angle.
 8. Use the battery "ON/OFF" switch to start and finish the spray application.
 9. Turn spray gun trigger-lock to "OFF" (unlocked) position when extension wand is not in use.

Be sure to
check out
The
Aprehend
Channel
on YouTube



Figure 1 Connect the extension wand to the spray gun as illustrated.

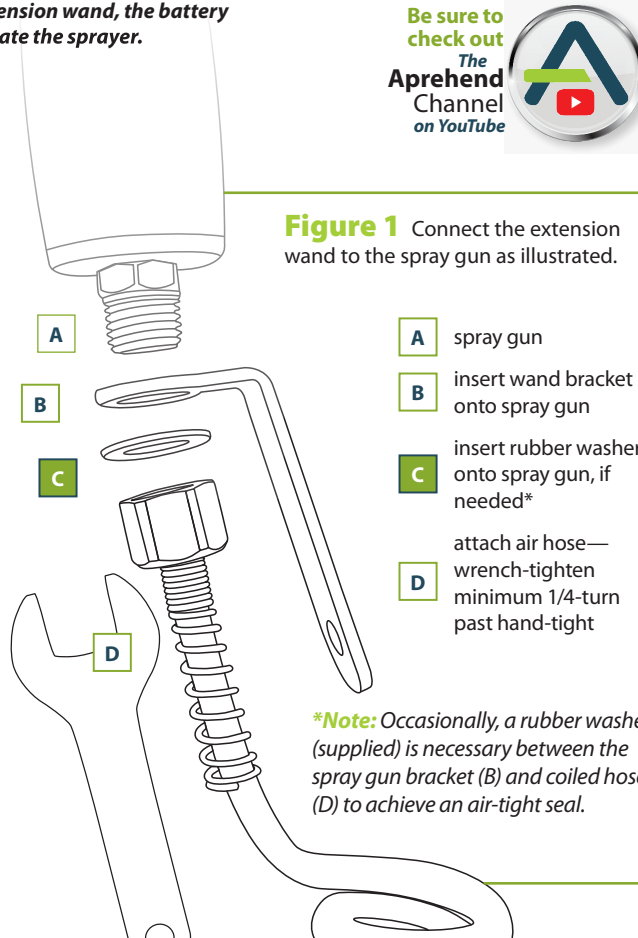

- A** spray gun
- B** insert wand bracket onto spray gun
- C** insert rubber washer onto spray gun, if needed*
- D** attach air hose—wrench-tighten minimum 1/4-turn past hand-tight

***Note:** Occasionally, a rubber washer (supplied) is necessary between the spray gun bracket (B) and coiled hose (D) to achieve an air-tight seal.

Figure 2 Press and twist to toggle between the Trigger-Lock "ON" (locked) and "OFF" (unlocked) positions.

ON (Locked)
Clockwise



OFF (Unlocked)
Counter-clockwise



Extension Wand Components

Spare lock nut, and rubber washer are supplied in case of loss.

- A) Extension Wand With Bracket
- B) Lock Nut, (1) installed on wand and (1) extra
- C) Rubber Washer, (1) installed on wand and (1) extra
- D) Wrench



Aprehend®
Biological Bed Bug Control

www.rockwelllabs.com